

PLAN
SCALE - 1 : 50 (TOTAL CAPACITY- 155000 LTRS.)
DETAIL OF U.G. WATER RESERVOIR (LOAD CAPACITY-45 M.T.)

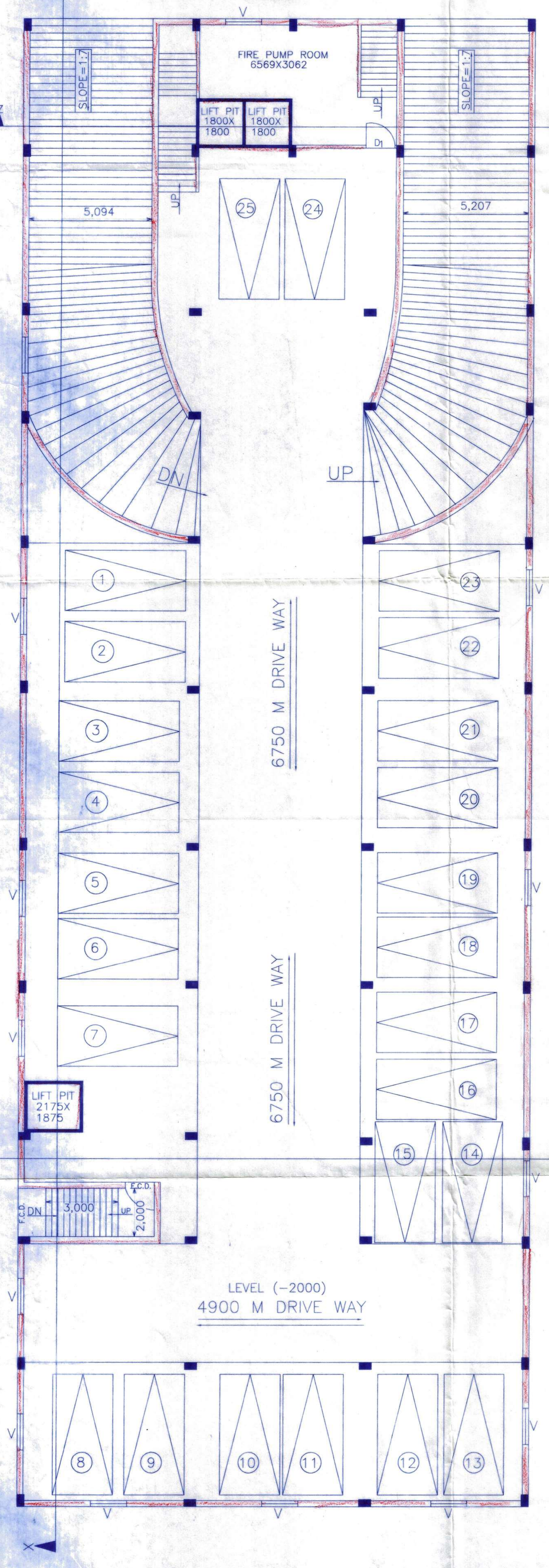
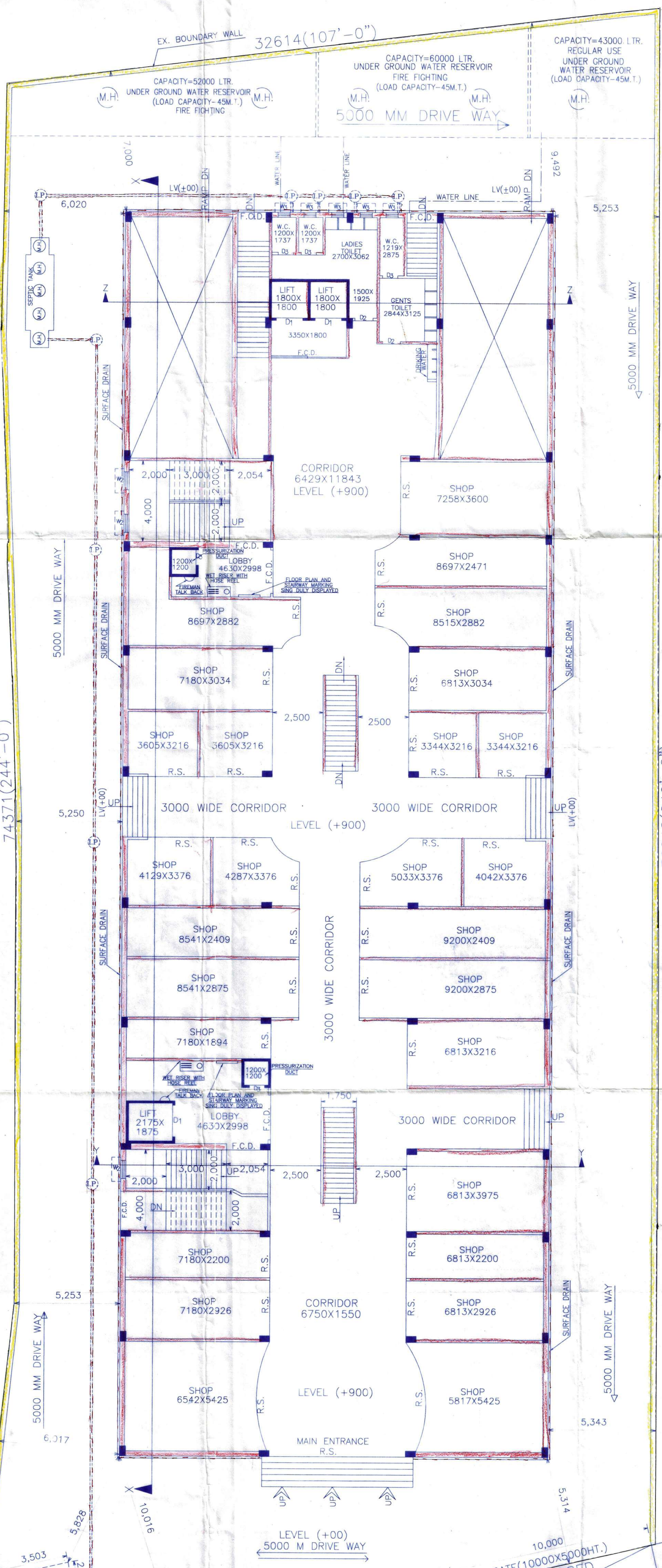
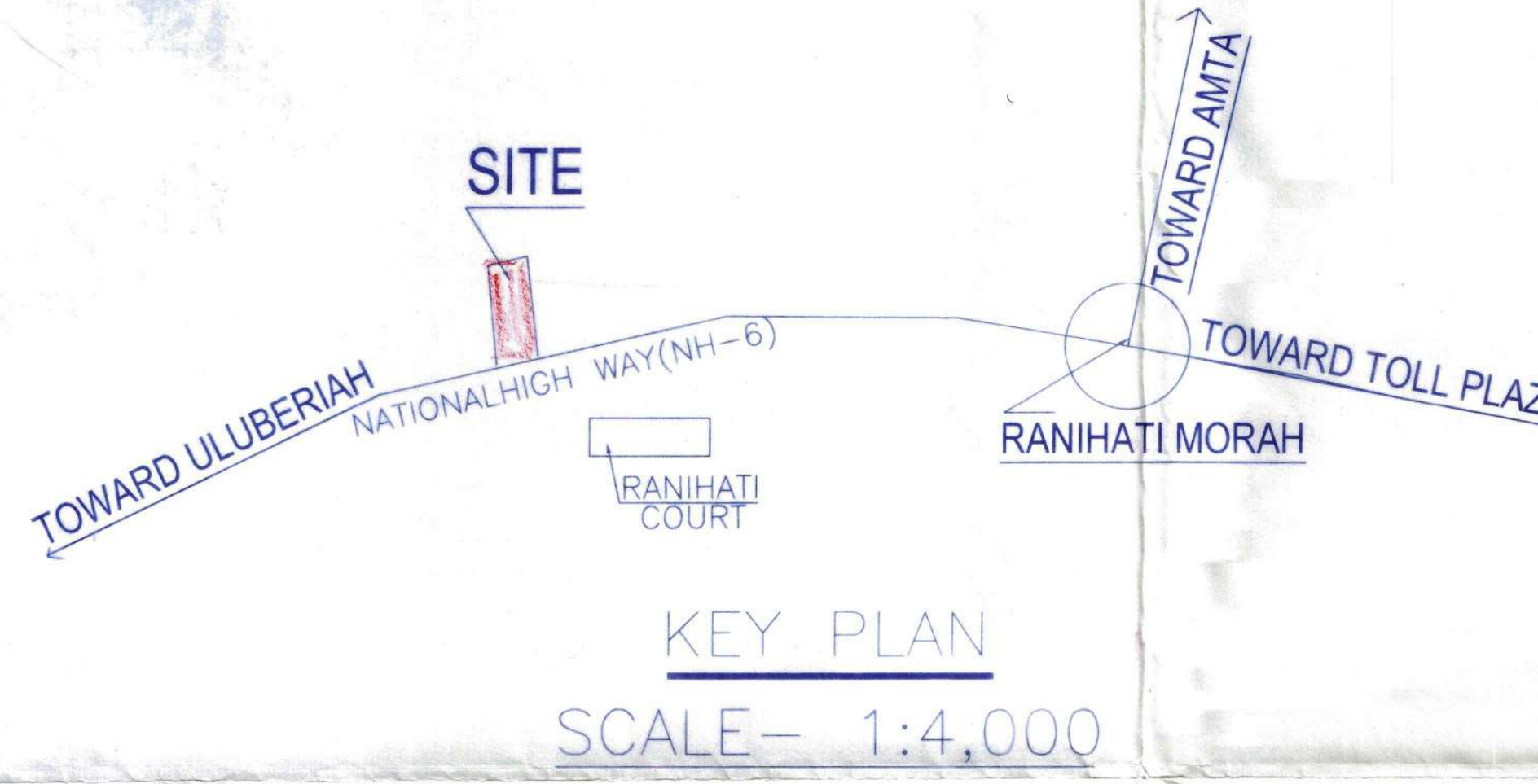
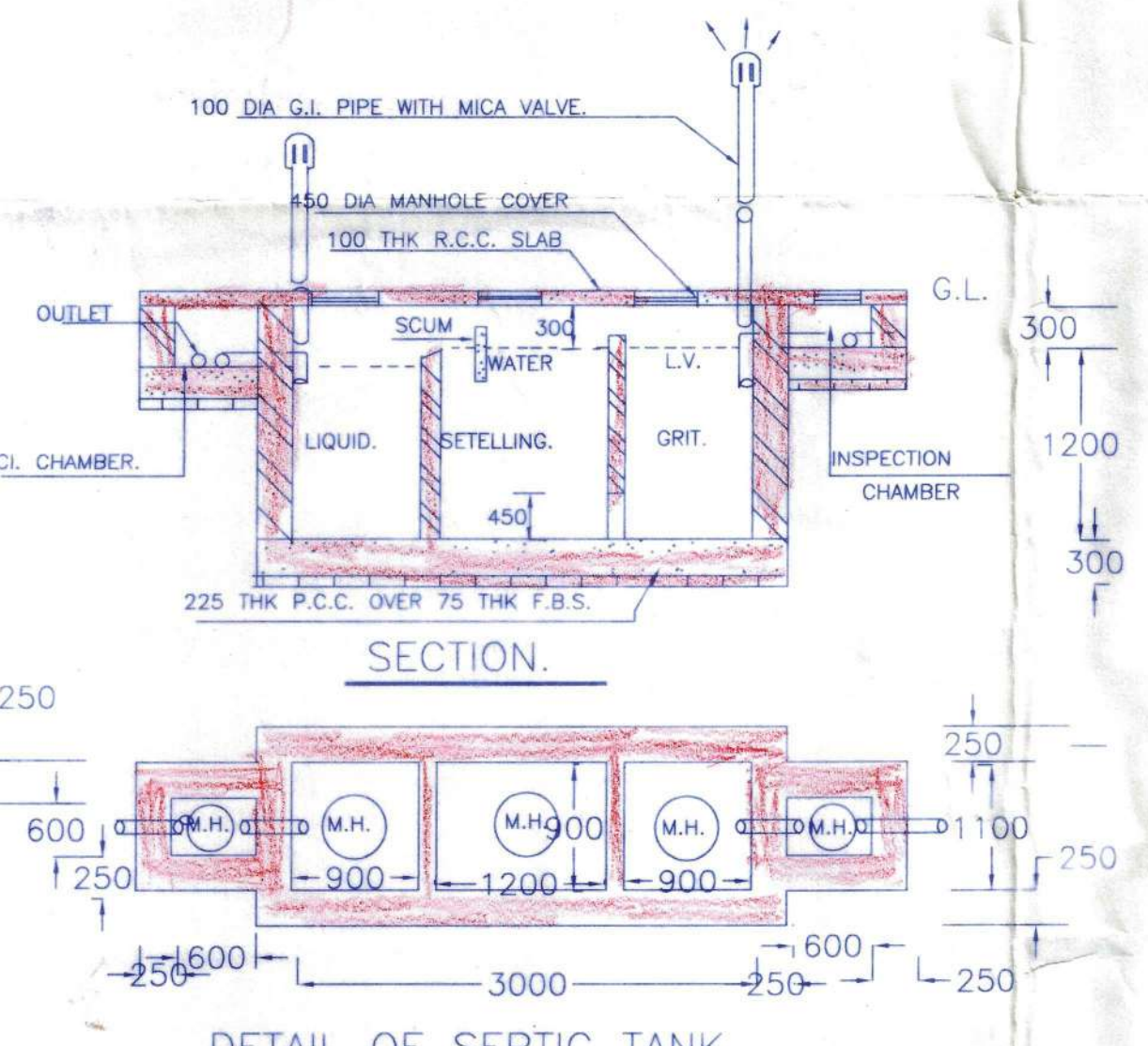

| VENTILATION - BASEMENT FLOOR 2.5% | |
|-----------------------------------|--|
| SPECIFICATION OF CONSTRUCTION | |
| 1. | 1ST CLASS CEMENT BRICK WORK IN SUPER STRUCTURE |
| 2. | 25CM THICK 1ST CLASS BRICK WORK 4:1 |
| 3. | LEAN CONC. 1:3:6 WITH 18MM DOWN GRADED STONE CHIPS. |
| 4. | R.C.C. 1:2:4 FOR ROOF SLAB, LINTEL, BEAM, COLUMN (M-20). |
| 5. | CEMENT SAND PLASTER 1:3:M. THICK ON OUTSIDE & INSIDE WALL. |
| 6. | 8MM THICK IN CEILING & R.C.C. CHAJJA. |
| 7. | 25M THICK I.P.S. FLOORING WITH NEAT CEMENT AT TOP INCLUDING SKIRTING. |
| 8. | M.S. FLAT ORNAMENTAL GRILL FITTING & FIXING COMPLETE. |
| 9. | 75MM THICK SINGLE LAYER BRICK FLAT SOLING IN FLOORING & FOUNDATION. |
| 10. | MILD STEEL BARS FOR COLUMN, BEAM, LINTEL & SLAB INCLUDING SAND, MEDIUM GRADE; CEMENT: ORDINARY PORTLAND. |
| 11. | HIRE & LABOUR FOR SHUTTERING OF R.C.C. WORKS INCLUDING STOUT TO BE PLACED AS PER DIRECTION. |
| 12. | SANITARY & PLUMBING FITTING & FIXING COMPLETE AS PER DIRECTION. |
| 13. | MATERIALS ARE TO BE USED: STONE CHIPS - 19MM DOWN GRADED. |
| 14. | SAND, MEDIUM GRADE; CEMENT: ORDINARY PORTLAND. |
| 15. | ALL OUTSIDE WALL 250MM M. & INSIDE WALL 150MM THICK. |
| 16. | WOOD WORK: SAL WOOD SHALL BE USED FOR DOORS FRAME & FLASH DOOR SHALL BE USED FOR SHUTTER. |
| 17. | COVER TO MAIN REINFORCEMENTS: a) FOUNDATION & COLUMN-40MM. |
| 18. | b) BEAM-25MM. c) SLAB-15MM. |
| 19. | GRADE OF STEEL WILL BE USED- FE-415 |
| 20. | BEARING CAPACITY OF SOIL AS PER SOIL TEST REPORT. |

| AREA STATEMENT. | |
|---|---|
| LAND AREA: AS PER DEED/PARCHA : | 59.00 DEC. = 2389.82 SQM. |
| LAND AREA: AS PER POSSESSION : | 59.00 DEC. = 2389.82 SQM. |
| PERMISSIBLE COVERED AREA: | 1593.21 SQM |
| PERMISSIBLE OPEN AREA: | 4.0 |
| PERMISSIBLE F.A.R.: | 796.61 SQM |
| PERMISSIBLE TOTAL FLOOR AREA: | 955.28 SQM |
| PROPOSED BASEMENT AREA: | = 1309.12 SQM |
| PROPOSED GROUND FLOOR AREA: | = 1309.12 SQM |
| PROPOSED FIRST FLOOR AREA: | = 1309.12 SQM |
| PROPOSED SECOND FLOOR AREA: | = 1309.12 SQM |
| PROPOSED THIRD FLOOR AREA: | = 1309.12 SQM |
| PROPOSED FOURTH FLOOR AREA: | = 1309.12 SQM |
| PROPOSED FIFTH FLOOR AREA: | = 1309.12 SQM |
| TOTAL FLOOR AREA: | = 9163.84 SQM |
| PROPOSED STAIR HEAD-ROOM: | 33.43 SQM = 33.43 SQM = 66.86 SQM |
| PROPOSED LIFT MACHINE ROOM: | 170.98 SQM = 171.5 SQM = 271.3 SQM |
| TOTAL FLOOR AREA (INCLUDING STAIR HEAD-ROOM & LIFT MACHINE ROOM): | 9273.83 SQM |
| TOTAL SERVICE AREA: | = 1309.12 SQM |
| TOTAL FLOOR AREA WITH OUT SERVICE AREA: | (9273.83 SQM - 1309.12 SQM) = 7964.71 SQM |
| PROPOSED F.A.R.: | 3.32 |
| WIDTH OF ROAD: | 41.00 M |

| SCHEDULE OF DOORS & WINDOWS | | | |
|-----------------------------|-----------|-----------|---------------------------|
| MARKED | SIZE | THICKNESS | TYPE OF PANEL |
| D1 | 1200*2000 | 30MM | FLASH DOOR |
| D2 | 900*2000 | 30MM | FLASH DOOR |
| D3 | 750*2000 | 30MM | FLASH DOOR |
| W1 | 1500*1200 | 30MM | STEEL WINDOW FULLY GLAZED |
| W2 | 1200*1200 | 30MM | STEEL WINDOW FULLY GLAZED |
| W3 | 600*600 | 30MM | STEEL WINDOW FULLY GLAZED |

PROPOSED PLAN OF B+G+5 MERCANTILE BUILDING "UNIQUE SHOPPING MALL" AT L.R. DAG.NO.-2708, L.R. KH:NO-5234, MOUZA-BIKHAKOLA, J.L. NO-18, P.S.-PANCHLA, DIST.-HOWRAH.

CERTIFICATE OF ARCHITECT
I CERTIFY WITH FULL RESPONSIBILITY THAT THE FOUNDATION AND THE SUPERSTRUCTURE OF THE BUILDING HAS BEEN DESIGNED BY ME CONSIDERING ALL POSSIBLE LOADS INCLUDING SEISMIC LOAD, WIND LOAD AS PER THE NATIONAL BUILDING CODE OF INDIA AND ALSO CONSIDERING THE BEARING CAPACITY AND SETTLEMENT OF SOIL AND CERTIFY THAT THE BUILDING IS SAFE AND STABLE IN ALL RESPECT.

Abhishek Sarkar
ABHISHEK SARKAR
B.E.CIVIL ENGINEER
M.B.E. (INDIA) & A.S. (INDIA)
REGISTERED CIVIL ENGINEER
REG. NO. 158 017 20
(STATE OF WEST BENGAL)
E.S.E. H.M.C. LICENSE NO. 4400

CERTIFICATE OF ARCHITECT
I CERTIFY WITH FULL RESPONSIBILITY THAT THE BUILDING PLAN HAS BEEN DRAWN AS PER PROVISION OF THE PREVAILING BUILDING RULES THE SITE CONDITION INCLUDING THE WIDTH OF THE ABUTTING ROAD CONFORM WITH THE PLAN THAT IT IS BUILDABLE AND NOT TANK OR FILLED UP TANK.

Mr. Minu Paul
Mr. Minu Paul
CIVIL ARCHITECT (INDIA)
L.B.A. No. CA/2002/2927
S. Dalrymple, Howrah-711002

SIGNATURE OF L.B.A.
SIGNATURE OF OWNER
THE PLOT AS PER SITE PLAN BELONGS TO ME AND IF THERE BE ANY LITIGATION INFUTURE THE RESPONSIBILITY WILL LIE WITH ME

Pranab Kumar Chatterjee
DIRECTOR

Validity of the Sanctioned Plan For Prop No 11/4/23

Sanctification means

Discussion

District Engineer / Asst. Engineer,
Hawrah Zila Faisalabad
(Signature)
11/4/23



Provisionally Sanctioned the Building Plan (Provisional / Conditional) Final subject to the following conditions:-
By Sgn. M/S. Kishor Infrastructure Pvt. Ltd.
11/4/23. Subject to the following conditions:-

- After Conversion of Non-Building Land in to Building Land use, the effective and drawn up a sanctioned building plan.
- Demolish the Old Structure Prior to the Construction of New Structure.

District Engineer / Asst. Engineer,
Hawrah Zila Faisalabad / Hawrah Zila Faisalabad
(Signature)
11/4/23

CONDITIONS OF SANCTION

ALL FOUNDATION SHOULD BE PROVIDED WITH BEARING CAPACITY OF SOIL. LOCATION AND SAFETY MEASURES OF STRUCTURE SHOULD BE CHECKED AS RECOMMENDED BY REGISTERED STRUCTURAL ENGINEER.

THE CONSTRUCTION SHOULD BE CARRIED UNDER THE SUPERVISION OF PAUNSHAD'S REGISTERED L.E.S.

District Engineer / Assistant Engineer
Hawrah Zila Faisalabad
(Signature)
11/4/23